

User's instruction for all-purpose air conditioner remote controller

Product Introduction

Model K-1028E All-purpose Air Conditioner Remote Controller has been designed to remotely control various brands and models of the air conditioners. This product is characteristic of point-to-point fast brand searching and automatic digital code searching with low power consumption, complete functions, long transmission distance, easy setting, simple operation and fresh visual appearance and comfortable hand feel which can facilitate you with unlimited convenience. The product has a large LCD screen which provides easy setting and operation. It has built-in clock, on/off timer and night illumination function which have facilitated more convenience for you.

Panel Description:

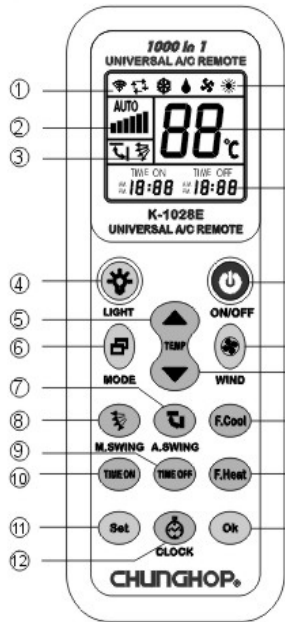

1. Signal Sending Display
2. Fan Display
3. Blowing Direction Display
4. Backlight
5. Temperature "+" key
6. Mode Key
7. Automatic Blowing Direction Control Key
8. Blowing Direction Control Key
9. Timing OFF Key
10. Timing ON Key
11. SET
12. Clock Function Key
13. Run Mode Display
14. Temperature Display
15. Model Code
16. Power Key
17. Fan Key
18. Temperature "-" key
19. Fast Cool Key
20. Fast Heat Key
21. Confirmation Button

Remarks:

Fast Cool/Heat Key

- Press "Fast Cool" key to automatically set the machine as refrigerating mode, 21°C, middle wind, automatic blowing direction;
- Press "Fast Heat" key to automatically set the machine as heating mode, 27°C, middle wind, automatic blowing direction.

Battery Installation:

1. Remove the battery cover of the remote control, install two new 7# batteries;
2. Install the battery cover. The time will appear in the left corner of LCD display.

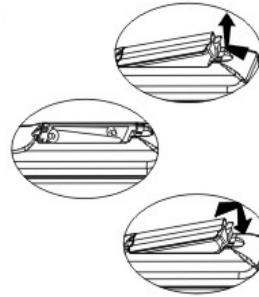

Setting of Remote Control

This remote controller has four setting modes that are marked as A, B, C and D. Please select one mode for operation.

A The brand corresponding point-to-point fast searching

1. Manually plug-in the air conditioner, aim the remote control at the receiving window of the air conditioner.

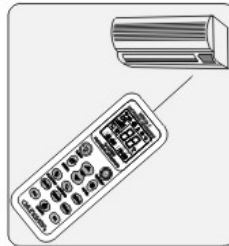

2. Press the code key that corresponds to your brand and hold until the air conditioner is started by giving out a sound signal. Release the key and the setting is completed.

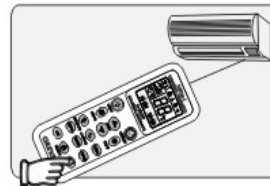

Table of brand corresponding keys

ON/OFF	TEMP	TEMP	WIND	MODE	M.SWING
GREE/Haier	MD/TO SHIBA /CHANGHONG	SHARP / KELONG	mitsubishi /OTHER	LG / SAMSUNG	HITACHI / Panasonic
A.SWING	TIME ON	TIME OFF	F.Cool	F.Heat	
SANYO / HISENSE	CHIGO / DAIKIN	FUJITSU / GARRIER	CHUNLAN /AUX	SHINCO / AUCMA	

B Manually input code

1. Manually plug-in the air conditioner, find the type of the air conditioner in the "Code Table", and find the first code, for example: **Haier**

BRAND	CODE
HAIER	001-019

2. Hold SET button (for about three seconds) until the conditioner type code flickers in the window, press Temperature "▲" or "▼" buttons until the desired code flickers in the window. When the code is right, the air conditioner will start.



3. Press OK button and the selected conditioner type code will stop flickering.

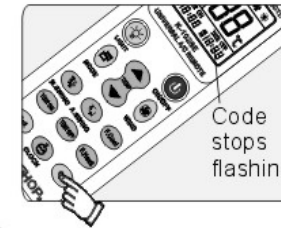

4. Test whether the remote control button has been effectively set. If yes, setting completes. And if no, repeat steps 2-3.

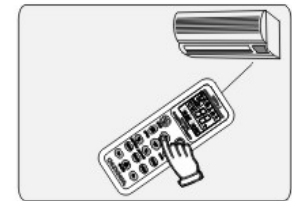

C Digital automatic search type

1. Manually plug-in the air conditioner, aim the remote control at the receiving window of the air conditioner.

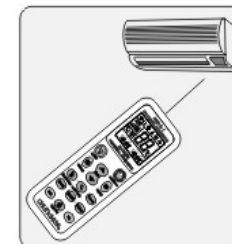

2. Hold SET button (for about six seconds) until the conditioner type code changes in the window, indicating you have entered the high-speed conditioner type search status. press OK button to stop searching until the air conditioner automatically starts.

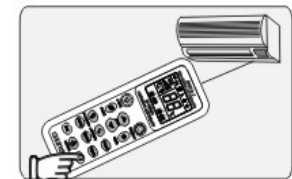

3
Test whether the functions of remote control buttons (excluding Temperature and buttons, timed ON/OFF buttons, and SET button) are correct. If yes, the code is effectively set. If not, press SET button to continue once the search.

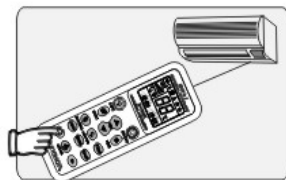

Set Time Function

Press CLOCK button (for three seconds) to enter the clock setting status, and the clock will flicker. Use the Temperature "▲" or "▼" buttons to adjust the current time, and press CLOCK button again to exit setting.

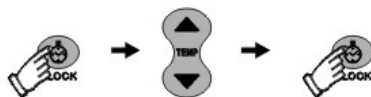

Timing ON/OFF Function

To configure the timer function of the original remote control, press TIME ON or TIME OFF buttons, and the air conditioner timer lights will go on, indicating the air conditioner has entered the timed status.

※The timed ON function of some of the air conditioner types is only valid only in the Power Off status.

Warm Tips:



- This remote control is effective if the air conditioner receiver works normally.
- If this remote control is intended to be not in use for a long time, please remove the batteries.
- It may possibly caused internal program disorder if this remote control is not operated correctly, in case of that, please take out the battery, and install the batteries 35 minutes later, then the remote control may recover normal.



Applicable brand and code list

Brand	Code	Brand	Code	Brand	Code	Brand	Code	Brand	Code
ACSOM	980	DAOTIAN	821-824	HYUNDAI	780-789	PEREG	998	TADI AIR	501,508,509,532
ADC	861	DELONGHI	900	INYCIN	475-483	PINSHANG XINHUA8AO	290	TADIRAN	501,508,509,532,630,969,978,979,991
AIDELONG	293-295	DUNAN	336	JIANGNAN	359	PILOT	902		
AITE	296-299	DONGXIA	334-335	JIALE	358	PUYI	862		
AKIRA	796-797	DONGXINBAO	260-268	JMSTAR	360	QIXING	393	TAIYA	862
AMCOR	501,508,509,532,973,978,979	ELCO	982	JINBEIJING	361-362	RAYBO	371-383	TCL	120-139
		ELECTER	981-986	JINDA	491-492	RHOSS	903	TEAC	850-859
AMICO	982	ELECTROLUX	471-474	JINSONG	363-365	RICAI	394	TECO	831-834
ALPIN	989-991,998	FEDDERS	878	JOHNSO	282	RIJIANG	395-397	TIANJINKONGTAO	424
AUCMA	210-229	FEIEDRICH	879	KANGLI	368-370	ROWA	383-385	TIANYUAN	425-428
AUX	180-199	FEIGE	829-830	KELONG	110-119	SACON	414	TOBO	250-269
AOKE	301-302	FEILU	240-249	KLIMATAIR	797-800	SAMSUNG	610-629	TONGLI	429-430
AOLI	300	FERROLI	901	KONKA	366-367	SANYO NEC	500-550,860	TOYO	825-828
APTON	862	FIRST	864	KRIS	804-805	SANZUAN	190	TOSHIBA	630-639
BAIXUE	299	FRESTECH	270-279	KT02_D001	283	SAPORO	861	TRANE	812-816
BEIJINGJINGDIAN	304	FUJITSU	700-719	KT02_D002	284	SAST	450-452	UNI-AIR	368-369
BIG-THUMB	331	GALANZ	140-149	KTY001	285	SENSOR	860	UTTLEDUCK	454-456
BOERKA	630	GARRIER	690-699,890-899	KTY002	286	SERENE	499	WANBAO	431-433
BOERKA	305-306		KTY003	287	SHAMEI	400	WANGZI	861	
BOSHI	310	GEER	342-343	KTY004	288	SHANGLING	403-409	WEILI	434-443,553-576
BOSHIGAO	308-309	GLEE	280	KTY005	289	SHANYE	862		
BORLER	307	GOLDSTAR	303	LG	600-609	SHANXING	401-402	WEITELI	444
CAIXING	311	GREE	000,020-039	LIANGYU	780	SHARP	720-739	WHIRLPOOL	770-774
CHANGFENG	190	GUANGDA	345-346	LIKEAIR	386-387	SHENBAO	410-411	WUFENG	445-446
CHANGFU	835-838	GUQIAO	344	LITTLESWAN	453	SHENGFENG	412	XINGHE	462-463
CHANGLING	312-323	HAIER	001-019	LONGHE	861	SHENGFENGFELU	413	XINLE	457-460
CHANGHONG	060-079	HELTON	863	LOREN-SEBO	801-803	SHINCO	200-209	XILENG	448-449
CHENGYUAN	324	HEMILTON	095	MCQUAY	790-795	SHINING	415	XINLING	461
CHIGO	080-099	HICON	391-392	MD	040-059	SHUANGLU	416-418	XIONGDI	862
CHUANGHUA	325-328	HISENSE	230-239	MEILING	388-391	SIGMA	447	YAIR	467-471,044
CHUANYAN	861	HITACHI	640-659	WINGXING,BOYIN	290	SOGO	291	YAOMA	470
COLROLLA	861	HONGYI	347	MITSUBISHI	551-599	SONGLINXIA	862	YIDONG	499
CHUNLAN	170-179	HUABAO	100-109	MITSUKA	904	SONGXING	419	YORK	775-779
CONSUL	993	HUAGAO	348	NATIONAL/Panasonic	660-689	SOVA	292	YUTU	484-490
CONROWA	337-341	HUAKE	349-350	NIKKO	810-811	SOVA	420	ZHONGYI	493-494
CORONA	760-769	HUAMEI	351-352	NISO	398-399	SOWA	862-863	ZUODAN	495
CROWN	861	HUANGHE	353	NISO	497	SOYEA	421-422	DIY	044,090,092,095
DAEWOO	332-333	HUALING	150-169	NORCA	994	SPEED	987		
DAIKIN	740-759	HUAWEI	281	OLYMPUS	995-996	SRTC	423	OTHER	496,498,821-828,839-849,865-877,905-976,999
DAJINXING	329-330	HUIFENG	354-356	OPAL	997	STARIGHT-AIRCON	880		
DAKE	861	HUIFENG	357,360	PANDA	464-466	SUNBURG	817-820		

※ This company reserves the right to interpretation of the User's Manual. Design and technical parameters may vary without notice.